

# KOBI®

## Vari-Focal IR Tube Camera

**HIGH POWERED  
REFLECTION IR LEDS  
(40,000 HOURS LED LIFE)**



**9~22mm Lens**

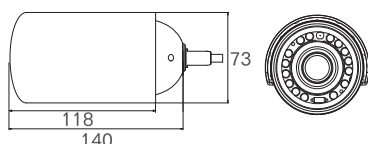
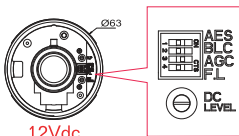
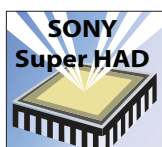

### FEATURES

**CAM75IRHR**

Image Sensor

DSP

Picture Elements

Horizontal Resolution

Minimum Illumination

Lens

IR Distance

IR LED

Scanning System/ Sync System

Electronic Shutter

White Balance

AGC

S/N Ratio

Video Output Signal

Operating Temp.

Power Consumption

Dimensions

Water Resistance

### SPECIFICATIONS

**K-33HCVF**

1/3" SONY Super HAD CCD

SONY HQ1 DSP

PAL: 795(H) x 596(V)

540 TV Lines

0.5 Lux @ F1.2 with IR Off, 0 Lux with IR On

9-22mm Vari-focal Aspherical Auto Iris Lens

Up to 15m

12 Super High Power Reflection LEDS

2:1 Interlace / Internal

AES Mode (On/Off) 1/50 (1/60) - 1/100000 Sec

Automatic

On/Off

More than 50dB (AGC Off)

Composite BNC Output 1.0Vp-p at 75 Ohm

-10°C -- +50°C

12VDC 350mA

185mm (L) x 73mm (W)

IP67

For more information  
contact Downs Protection  
**07 4633 1112**  
info@downsprotection.com.au

